

COAST FRESHE BARREL

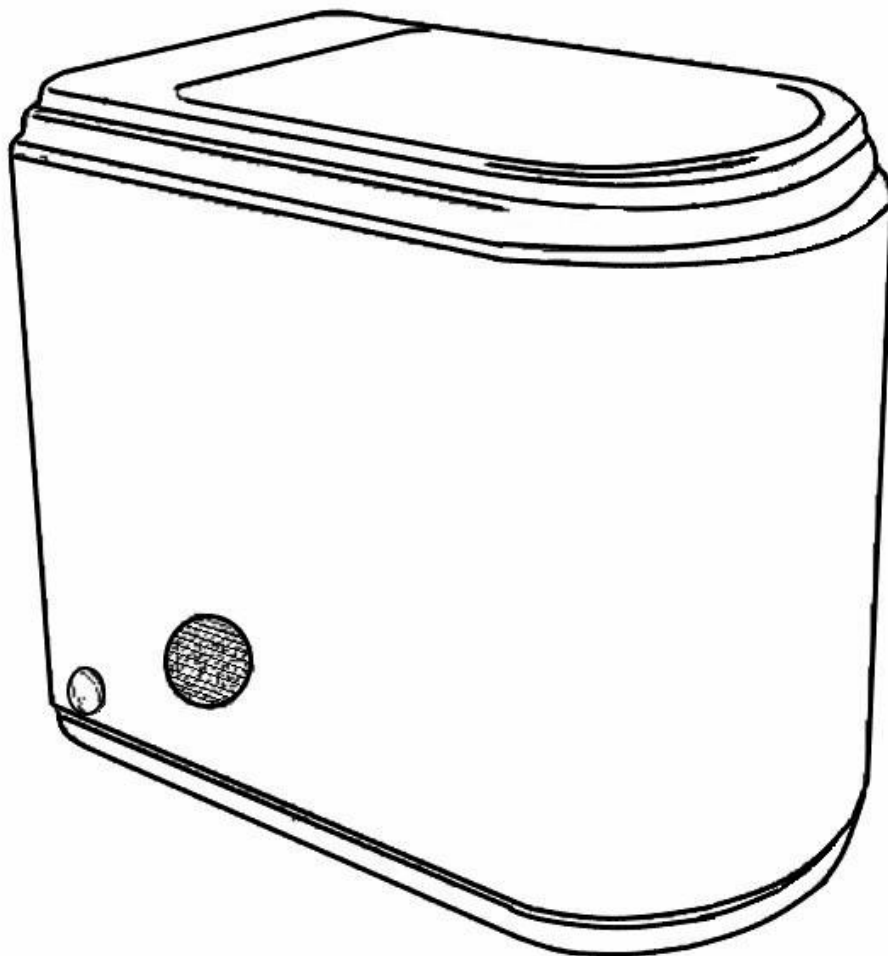

Coast Spas®



At Coast Spas, we are dedicated to promoting health and wellness through our Hot Tubs, Swim Spas and Coast Freshe Cold Plunges. Our products are designed to help you relax, reduce stress levels, ease muscle tension, soothe joint pain, and enhance your cardiovascular system. We are passionate about crafting immersive experiences that enrich your quality of life, and we are committed to providing you with the most captivating and transformative well-being solutions available.

Our products are built with cutting-edge technology and unparalleled quality, which has earned us the reputation of being the "World's Best Built Spas". We offer a curated selection of products that are designed to elevate your overall well-being to new heights. Our champion product within this health and wellness product line is the Coast Freshe Barrel. This remarkable addition is designed to help you recover faster, reduce inflammation, and improve circulation. It is perfect for anyone looking to improve their overall well-being and athletes and fitness enthusiasts.

At Coast Spas, we go above and beyond industry standards to set new benchmarks. We aspire to provide you with the most captivating and transformative well-being solutions available, and we invite you to embark on a journey toward a healthier, more fulfilling lifestyle with us. Our products are perfect for year-round use, personal retreats, socializing, and entertaining. We understand that each of our customers has unique needs and desires, which is why we've designed our hot tubs and swim spas to meet a variety of needs, from relaxation and stress relief to therapy and rehabilitation.

Thank you for choosing Coast Spas.

CONGRATULATIONS!



YOU'RE ALMOST READY TO ENJOY YOUR NEW COAST FRESHE BARREL!

Before you begin to enjoy your Coast Freshe Barrel, please take a moment to submit your warranty. For registering your Coast Freshe Barrel, you will need the Coast Freshe Barrel serial number. The sample picture below will help you locate the serial number.



Register your Coast Freshe Barrel by using the following link.



FOR YOUR REFERENCE

Owner's name:

Address:

Contact:

Email:

Serial number:

Purchase Date:

Dealer Name:

Delivery Date:

If you have any questions about your Coast Freshe Barrel, contact your authorized Coast Spas dealer. Their trained professionals can assist with parts, setup, operation, maintenance, and technical support.







DISCLAIMER: At the time of print, this manual is accurate in its information. Coast Spas reserves all the rights to change/ modify any designs and/or features without notification. To check updates or for other information, please visit <http://www.coastspas.com/>

Unloading & Unboxing Instructions

SAFETY FIRST

Your Coast Freshe Barrel unit is large and heavy — improper handling may lead to injury or product damage. Please review the following safety guidelines before unloading:

General Safety



-  Team Lift Only – Requires two or more people to lift or move. Never attempt to lift alone.
-  Wear Safety Gloves & Footwear – Protect hands from sharp edges and feet from impact injuries.
-  Do Not Drop or Tip Over – May cause damage to the structure or internal components.
-  Keep Children & Pets Clear – Keep the area clear during unboxing and setup.
-  Use Proper Lifting Techniques – Bend at the knees, not the waist. Keep your back straight.
-  Lift From Designated Points – Only lift from stable, reinforced areas indicated on the box.

Handling Tip

 Use the Built-In Plastic Handles – Your cold plunge is packaged with two plastic handles, one at the front and one at the back of the box. These handles are designed to assist with lifting and maneuvering the unit safely.

➤ Do not lift from the sides of the box or attempt to drag the unit.

Equipment Safety

-  Use tools like a pallet jack, dolly, or forklift if available.
-  Do not use straps around the unit body for lifting — they may compress or deform the shell.

Unloading Instructions

Prepare the Area

Clear a space wide enough to maneuver the unit. Confirm the drop-off location is level and safe for unloading.

Inspect Upon Delivery

Before signing the delivery receipt, inspect the box and pallet for damage. Take photos of any damage and note it on the delivery form.

Unloading Options

With Equipment: Use a forklift or pallet jack to move the product safely.

Without Equipment: Have 2–4 people lift using the plastic handles at the front and back.

Avoid dragging or rolling unless specified as safe by the manufacturer.



Unboxing Instructions

Remove Outer Packaging

Use a box cutter or scissors with caution — do not cut too deep. Remove shrink wrap, straps, and foam padding.

Check Package Contents

Coast Freshe Barrel

Make sure the Coast Freshe Barrel is the correct color and came with the ordered accessories

Scan this QR code to access your Coast Freshe Barrel Warranty Card



Inspect the Product

Look for dents, cracks, or missing components. Contact us within 48 hours if anything is missing or damaged.

Dispose of Packaging Safely

Do not leave plastic wrap or foam where it could be a tripping hazard. Recycle where possible.



Quick Tips

- If the unit is not installed immediately, store upright on a flat surface.
- Do not expose the unboxed unit to direct sunlight or rain until it's installed.
- Keep the serial number (usually located on the inside lip) for your warranty records.
- Click this link for your Coast Freshe Barrel Warranty card

Coast Freshe Barrel Lid

To avoid breaking your Coast Freshe Barrel lid, always handle it with care, using two hands and lifting from the underside. Avoid hitting or bumping the lid against the barrel and place it in a safe spot when not in use. The lid is made of acrylic, so be mindful when handling it.

Here's a more detailed breakdown:

- Handling:

When removing or installing the lid, stand directly in front of the Coast Freshe Barrel and hold the lid on the left and right sides.

- Placement:

When you're not using the lid, store it in a secure location to prevent it from being bumped or dropped.

- Durability:

Remember that the Coast Freshe Barrel lid is made of acrylic and can be damaged, especially if dropped or hit.

Table of Contents

Page 1 – Cover Page
Page 2 – Thank You Letter from Coast Spas
Page 3 – Registering Your Coast Freshe Barrel
Pages 4–5 – Unloading & Unboxing Instructions
Page 6 – Coast Freshe Barrel Cover
Page 7 – Table of Contents
Page 8 – Basic Information
Page 9 – Coast Freshe Barrel Surface & Transportation
Pages 10–13 – Important Safety Instructions
Pages 14–16 – Coast Freshe Barrel Setup Instructions
Pages 17–18 – Chiller Control Panel Instructions & Quick Reference Card
Page 19 – Connecting Your Coast Freshe Barrel to Home Wi-Fi
Pages 20–36 – Coast Freshe Barrel App Setup Instructions
Pages 37–44 – Draining & Winterization Instructions
Pages 45–46 – Glossary of Terms
Page 47 – Barrel Layout & Specifications
Pages 48–49 – Maintenance Procedures
Pages 50–51 – Chemical Information
Pages 52–55 – Troubleshooting Guide
Page 56 – Chiller Defrosting Information
Page 57 – Water Clarity Troubleshooting
Page 58 – Coast Freshe Barrel How-To Videos
Page 59 – Coast Freshe Barrel Service Log



PLEASE READ THE ENTIRE OWNER'S MANUAL BEFORE OPERATE THE COAST FRESHE BARREL

Basic Information

Water Care

IMPORTANT: Caring for your water by ensuring proper chemical usage is the single most important thing you can do to keep your Coast Freshe Barrel in good condition.

WARNING: Improper chemical usage and maintenance will quickly lead to severe issues with your Coast Freshe Barrel and can affect the equipment, jets, pumps, and all other components in contact with the water.

All Coast Freshe are susceptible to damage from unbalanced water.

Always maintain your water chemistry within the following parameters.

pH	7.2 - 7.8
Chlorine	1.0 - 3.0 ppm
Bromine	2.0 - 5.0 ppm
Total Alkalinity	100 - 120 ppm
Calcium Hardness	150 - 250 ppm

Always test water at least 2–3 times per week with a test strip.

Avoid high chlorine levels as they can damage chiller components.

Adjust pH before alkalinity if out of range, since alkalinity stabilizes pH.

Electrical

120VAC: requires an isolated 15 Amp circuit breaker, an isolated circuit with no other appliances or lights on the circuit at any time. Extension cords are not to be used in conjunction with the operations of the Coast Freshe Barrel. Low voltage damage could result, and this is not covered under warranty.

IMPORTANT: Coast Freshe Barrel operate with 110V - 120V.

NOTE: All components must be 120V. No 240V components allowable.



PLEASE READ THE ENTIRE OWNER'S MANUAL BEFORE OPERATE THE COAST FRESHE BARREL

Basic Information

Surface

Your new portable Coast Freshe Barrel must be placed on a firm, flat, and level surface, so that the weight is supported uniformly. Wood decking or balconies must be constructed to support a total weight of 1500 lbs. Refer to the local and current building codes in your area. Should your new Coast Freshe Barrel need to go through the gate or space – restricted area, ensure you've communicated those limitations with your dealer to avoid delivery complications.

NOTE: Damage caused by alternate decking methods may void the Coast Freshe Barrel warranty. Contact your dealer if you have any questions regarding location and placement.

Transport

Your new Coast Freshe Barrel has left the factory cleaned and polished and ready to begin operation after passing our many quality and operational tests. However, depending on your location in the world, your Coast Freshe Barrel may have spent days or even weeks in transit before arriving at your home. Please ensure that before filling up or operating your Coast Freshe Barrel that you check all electrical and plumbing connections are securely connected in the equipment area as they might have loosened during shipping. If any dirt has accumulated, you will want to remove it with a clean cloth or sponge using warm water.

DISCLAIMER: Coast Spas is not responsible for any damage to the Coast Freshe Barrel unit that may occur because of improper loading, unloading, or transport method on a customer's or delivery vehicle. Additionally, any injuries sustained during the lifting, moving, or handling of the Coast Freshe Barrel unit are the sole responsibility of the customer. It is strongly recommended to use proper lifting techniques and sufficient manpower or equipment when transporting the unit to avoid damage or injury.

IMPORTANT SAFETY INSTRUCTIONS READ AND

FOLLOW ALL INSTRUCTIONS CAREFULLY

DANGER: Risk of Injury. The suction fittings in this Coast Freshe Barrel are sized to match the specific water flow created by the pump. Never operate the Coast Freshe Barrel if the suction fittings are broken or missing. Never replace a suction fitting with one rated less than the flow rate marked on the original suction fitting.

COAST FRESHE BARREL

DANGER: Risk of Accidental Drowning. Do not allow children to be in or around Coast Freshe Barrel. Keep the Coast Freshe Barrel cover on and lock when not in use.

DANGER: Risk of Electrical Shock. The electrical supply for this product must include a suitably rated switch or circuit breaker to open all ungrounded supply conductors to comply with section 422-20 of the National Electrical Code, ANSI/NFPA 70. The disconnect must be readily accessible and visible to the Coast Freshe Barrel occupant but installed at least 5 feet (1.5 m) from the Coast Freshe Barrel water.

WARNING: Only use this product with 120V/60Hz electrical circuit; outlet must be grounded.

WARNING: Do not permit electric appliances (such as lights, telephone, radio, television, etc.) to be within 5 feet (1.5m) of this Coast Freshe Barrel.

CAUTION: Connect only to a circuit protected by a Class A ground fault circuit interrupter or residual current device.

CAUTION: To ensure continued protection against shock hazard, use only identical replacement parts when servicing.

CAUTION: Test the ground fault circuit interrupter before each use of the Coast Freshe Barrel.

CAUTION: Read the instruction manual.

WARNING: Prolonged immersion in cold water may induce hypothermia. Review the important Hypothermia signs and symptoms listed below.

Mild Hypothermia: shivering, goose bumps, difficulty with complex motor skills.

Moderate Hypothermia: violent shivering, sluggish, speech problems, difficulty with fine motor skills.

Severe Hypothermia: rigid muscles, dazed, shivering has stopped, blue skin, erratic heartbeat, unconscious.

WARNING: Children should not use Coast Freshe Barrel without adult supervision.

WARNING: Do not use Coast Freshe Barrel unless all suction guards are installed to prevent body and hair entrapment.

WARNING: People with infectious diseases should not use a Coast Freshe Barrel.

WARNING: People using medication and/or having an adverse medical history should consult a physician before using Coast Freshe Barrel.

WARNING: Do not use Coast Freshe Barrel immediately following strenuous exercise.

WARNING: Prolonged immersion in Coast Freshe Barrel may be injurious to your health.

CAUTION: Adequate drainage and ventilation must be provided if the equipment is to be installed in a pit.

CAUTION: When using this electrical equipment, basic safety precautions should always be followed.

WARNING: To avoid injury, exercise care when entering or exiting the Coast Freshe Barrel.

WARNING: Do not use drugs or alcohol before or during the use of Coast Freshe Barrel to avoid unconsciousness and possible drowning. The use of alcohol or drugs can greatly increase the risk of fatal hypothermia in Coast Freshe Barrel.

WARNING: Pregnant or possibly pregnant women should consult a physician before using a Coast Freshe Barrel.

COAST FRESHE BARREL

WARNING: The equipment and controls shall be located no less than 1.5 meters horizontally from the Coast Freshe Barrel.

CAUTION: Observe a reasonable time limit when using the Coast Freshe Barrel. Extended use increases the risk of hypothermia. Symptoms such as severe shivering, confusion, speech difficulties, loss of motor control, muscle rigidity, blue skin, or an irregular heartbeat.

CAUTION: Enter and exit the Coast Freshe Barrel slowly. Wet surfaces can be very slippery.

CAUTION: Proper chemical maintenance of Coast Freshe Barrel water is necessary to maintain safe water and prevent possible damage to Coast Freshe Barrel components.

CAUTION: For use only within an enclosure rated CSA Enclosure 3.

CAUTION: When using this electrical equipment, basic safety precautions should always be followed.

CAUTION: The owner should test and reset the GFCI or RCD on a regular basis to verify its function.

WARNING: Maintain water chemistry in accordance with the Manufacturer's instructions.

CAUTION: Close the cover when not in use. This will help to discourage unsupervised children from entering the Coast Freshe Barrel. There is no representation that the cover, clip tie-downs, or actual locks will prevent access to the Coast Freshe Barrel.

CAUTION: Turn off the chiller immediately if the water is not flowing as it can cause ice to build up and damage the chiller unit.

CAUTION: To prevent damage to the chiller unit and plumbing system, drain, winterize,

and properly store the Coast Freshe Barrel if the ambient temperature drops to 36°F (2°C) or below, especially during winter.

Advisory: Any necessary repair must be carried out by a Coast Spas Authorized Service Provider. Coast Spas cannot accept liability for any damage resulting from alteration or repair performed by nonauthorized technicians.

Advisory: Only professional or certified technician should perform any work on the system.

WARNING: Keep access door always closed.

WARNING: Disconnect electric power before servicing.

WARNING: Shock hazard! No user serviceable parts inside.

WARNING: Do not attempt to service this control system. Contact your dealer or service provider for assistance.

WARNING: Follow instructions for all power connections as outlined in the owner's manual.

IMPORTANT NOTICE

Upon initial receiving of the chiller after transport and whenever moving it without keeping the unit level upright or unit had tilted. Ensure the unit remains upright for a minimum of 6 – 12 hours before connecting it to power.

CAUTION

Do not turn the chiller upside down.

Failure to follow this guideline may cause damage to the Coast Freshe Barrel chiller.

Placing the Chiller and Ensuring Proper Ventilation

Chillers operate by transferring heat from one location to another. Specifically, a water chiller removes heat from the water and releases it into the surrounding air. To achieve this efficiently, **adequate airflow** is essential for optimal performance.

If the Coast Freshe Barrel is placed in a hot or poorly ventilated area, its ability to dissipate heat is significantly reduced, lowering its cooling effectiveness. Additionally, if the hot exhaust air from the chiller is recirculated back into its intake, the performance is compromised.

CAUTION

CLOSE THE COVER WHEN NOT IN USE.

THIS WILL HELP TO DISCOURAGE UNSUPERVISED CHILDREN FROM ENTERING THE COAST FRESHE BARREL. THERE IS NO REPRESENTATION THAT THE COAST FRESHE BARREL COVER WILL PREVENT ACCESS TO THE COAST FRESHE BARREL

KEEP AIR VENTS UNOBSTRUCTED AND FREE FROM NEARBY OBJECTS. ROUTINELY CLEAN THE VENT SCREEN TO ENSURE PROPER VENTILATION AND OPTIMAL SYSTEM PERFORMANCE.

DO NOT CONNECT THE POWER UNLESS THE COAST FRESHE BARREL IS FILLED WITH WATER. OPERATING WITHOUT WATER CAN CAUSE DAMAGE TO COMPONENTS AND WILL VOID THE WARRANTY.

ADEQUATE DRAINAGE AND VENTILATION MUST BE PROVIDED IF THE EQUIPMENT IS TO BE INSTALLED IN A PIT.

WARNING

Water chiller is equipped with a **GCFI plug**, making it compatible with **110V - 120V 15A outlets** the pre-installed cord is approximately 15 feet long. For optimal safety and performance, it is **recommended** to plug the chiller directly into a wall receptacle, avoiding the use of power strips.

If an **extension cord** is needed, it must be 12-gauge to provide sufficient power to the chiller and should not exceed 25 feet in length. ensure that it is a **12 AWG** cord with a single plug end (avoid multi-tap extensions).

After plugging in, **verify that the GFI** is in the **reset position** to ensure proper functionality and safety.

The Please refer to the local electrical code requirements.

Ensure the power plug is firmly inserted into the socket outlet. Poor contact due to improper insertion may cause overheating and component failure, potentially leading to short circuits or a fire hazard.

Unplug the power during lightning storm and when not in use for an extended period to prevent short circuits, which could shorten the lifespan of the components and pose a fire hazard.

Do not handle the power plug or cord with wet hands to prevent the risk of electrical shock or serious injury.

Coast Freshe Barrel – Water Filter Cartridge Installation Instruction

Unbox and Prepare Components

Carefully remove all components from the box. Your Coast Freshe Barrel came with a filter cartridge in a plastic bag and a filter wrench (tool).

Install the Filter

1. Remove the access door. Start by detaching the top edge of each panel by gently pulling it outward at an angle to release the magnets. The lift the ventilation screens upward to fully remove it.
2. Locate the filter housing inside.
3. Use Wrench to open canister.

Proper Filter Insertion

1. Insert the filter cartridge.
2. Reattach the housing and hand-tighten.
3. Use the wrench provided to secure the seal.

IMPORTANT NOTICE

Note the Flow Rate

- During installation, observe the initial water flow rate.
- A decrease in flow indicates the need for filter cleaning.
- Proper flow is essential for the Coast Freshe Barrel performance.

OWNER'S MANUAL
Filter Maintenance

The Filter cartridge replacement depends on the Coast Freshe Barrel usage and maintenance. Please contact your closest Coast Spas authorized dealership for more information

- Check the filter weekly.
- If you notice reduced water flow, clean the filter immediately.
- Never operate the chiller with inadequate water flow.

CAUTION

Do not use the Coast Freshe Barrel without a filter cartridge installed.

If you notice **no water flow** or suspect that the flow is not normal, **immediately power off and unplug** the Coast Freshe Barrel. Contact the **selling dealer's service department** for assistance.

Damage caused by slow flow due to improper setup or lack of maintenance is not covered under the warranty. Always ensure proper installation and regular filter cleaning to maintain optimal performance.

Failure to clean the filter housing and replace the filter cartridge regularly, leading to slow or no water flow, may result in chiller damage. Coast Spas is not responsible for damage caused by improper maintenance.

IMPORTANT NOTICE

The Filter must be cleaned or replaced when required. Regular maintenance ensures optimal performance and prevents damage to the chiller.

The need for replacement may vary based on the following factors:

- **Usage frequency** – More frequent use may require more regular cleaning.
- **Personal hygiene** – Residues from lotions, oils, or sweat can clog the filter faster.
- **Environmental conditions** – High pollen levels, dust, or outdoor placement may necessitate more frequent cleaning.

To maintain **proper water flow and efficiency**, always inspect the filter **weekly** and maintain as needed.

Coast Freshe Barrel Start-up Instructions

- Connect a garden hose to a tap and carefully place it into the Coast Freshe Barrel.
- Begin filling with water
- Check for leaks as the water level rises
- Fill up to 4-5 inches below the top edge. Adjust for users' weight and height.

IMPORTANT NOTICE

Draining and Winterization Guide for the Coast Freshe Barrel

The **Coast Freshe Barrel** is designed to withstand various weather conditions but is **not rated for freezing temperatures**. If the temperatures in the area drop **to 32°F (0°C) or lower**, you must **winterize the unit** to prevent damage.

If the **temperature is expected to stay below freezing for more than 12 hours**, follow these steps to **properly store and protect your Cold Plunge system**:

Step-by-Step Draining and Winterization Process

Step 1: Power Down the System

- Turn off the chiller and unplug it from the power source.

OWNER'S MANUAL

- Ensure the system is powered down before proceeding.

Step 2: Open the External Drain

- Locate the **external drain valve** underneath the chiller.
- Remove cap and turn the **ball valve** to the open position to allow water to drain.

Step 3: Manage Water Drainage

- If needed, **connect a garden hose** redirect water to drainage.
- Ensure to comply with **local drainage regulations**.

Step 4: Fully Drain the Plunge

- Even after water stops flowing from the external drain, some water may remain in the internal plumbing.
- Use a **shop vac** to remove any remaining water.

Step 5: Disconnect and clean the Water Filter Housing

- Disconnect the **water filter housing** and **remove the filter**.
- Wipe away any residual water inside the **filter housing**.
- Reattached the filter housing back on.
- Discard the used pleated filter cartridge.

Step 6: Store the Coast Freshe Barrel Properly

- Once fully drained, clean the interior and exterior using a mild cleaning solution to remove bacteria, residue, and other contaminants.
- Store the unit **upright and indoors**.
- Use **cover** to safety and protected from dust and debris.

Final Check

- Confirm that **all water has been removed** from the system, including the filter housing.
- Use a **sponge or towel** to soak up any remaining moisture before storage.

By following these steps, you can **prevent damage** and **extend the lifespan** of your Coast Freshe Barrel, ensuring it remains in optimal condition for future use.

WARNING

Always **follow proper winterization steps** and ensure **your Coast Freshe Barrel is stored correctly during freezing conditions**.

Important Warranty Information

Please be aware that **damage caused by freezing temperatures or improper water chemistry is not covered under the warranty**.

Cold Weather Monitoring & Winterization

- When **outdoor temperatures approach freezing (32°F / 0°C)**, **monitor your** Coast Freshe Barrel **daily** to ensure proper **flow**.
- If temperatures will remain **below freezing for 12 hours or longer**, you must **fully drain and winterize** the Coast Freshe Barrel, including the **filter housing and chiller**, to prevent damage.

Liability Disclaimer ● Coast Spas is not responsible for repairs or replacement to any damages occurs to the Coast Freshe Barrel that is left outdoors in freezing conditions without being properly drained/ stored.

- Customer may contact selling dealer/ service provider for repairs, but any damage caused by freezing will not be covered under warranty.

Preparing Your Coast Freshe Barrel for Peak Winter Performance

As winter approaches, take the necessary steps to ensure your Coast Freshe Barrel is operating at its best and ready for colder temperatures. Follow these essential maintenance tips to keep your system running smoothly.

1. Keep the filter clean and replace the Filter Cartridge for Optimal

Water Flow A clean filter ensures efficient water circulation and performance.

- **Inspect** the filter regularly for debris or buildup that may obstruct water flow.
- **Maintain Performance:** Clean the filter housing or replace the filter cartridge as needed to keep water moving efficiently.

2. Keep the Water Flowing

Proper water circulation is crucial for preventing freezing and reduced flow can lead to system shutdown or ice formation if surrounding temperature is near freezing.

- **Daily Flow Check:** Ensure a steady stream of water circulating water means system is functioning correctly.
- **Troubleshoot Flow Issues:** If water flow decreases, take immediate action to resolve the issue. If unable to restore flow, **drain and winterize** your **Coast Freshe Barrel** to prevent damage.

3. Preparing for Freezing Conditions

For those in **regions where temperatures drop below freezing for extended periods**, additional winterization steps may be required.

By following these key maintenance steps, you can ensure that your **Coast Freshe Barrel** remains in peak condition throughout the winter season.

Protect Your Coast Freshe Barrel from Freezing Winter Condition

As winter sets in, it's crucial to **safeguard your Coast Freshe Barrel** from extreme cold. Follow this guide to maintain peak performance and prevent winter-related damage.

1. Daily Temperature Monitoring • Stay informed about local weather

conditions.

- If temperatures are expected to drop **below freezing (32°F / 0°C) for more than 12 hours**, take preventive measures to protect your system.

2. Maintain Proper Water Temperature or Winterize

- If you plan to **use your Coast Freshe Barrel in winter**, set the temperature to **50°F (10°C) or above** to account for natural drops in water temperature. This helps prevent freezing and ensures optimal system performance.
- If you **do not wish to use it during winter**, **fully drain, winterize, and store** your Coast Freshe Barrel in a **safe location** away from freezing weather elements.

3. Full Drain to Prevent Freezing Damage

- If freezing conditions persist, **fully drain your Coast Freshe Barrel** following the step-by-step instructions in the owner's manual. • Proper drainage ensures that no residual water remains in the system, preventing ice formation and potential damage.

4. Severe Weather Precautions

If a **winter storm or power outage** is expected, act proactively:

- **Fully drain** your Coast Freshe Barrel to prevent water from freezing inside the system.
- **Store the chiller and water filter canister indoors** in a warm location to protect them from freezing temperatures.

OWNER'S MANUAL

- Detailed storage and winterization instructions can be found in the **owner's manual**.

5. Preparing for Extended Absences

If you plan to be away for **more than 24 hours during freezing weather**, take precautionary steps:

- **Fully drain** the system to prevent freezing damage.
- **Store the chiller and water filter indoors** in a warm place to keep components safe from extreme cold.

By following these **winter maintenance steps**, you can protect your **Coast Freshe Barrel** from freezing temperatures and ensure **reliable performance year-round**.

COAST FRESHE BARREL

GLOSSARY OF TERMS



10" PLEATED FILTER CARTRIDGE: Coast Freshe Barrel high-efficiency filtration element designed to capture dirt, sediment, and other particles from water. The pleated design increases surface area for improved filtration.



10" CLEAR FILTER HOUSING: A durable, transparent housing designed to accommodate the Coast Freshe Barrel 10-inch water filters. It allows for easy visual inspection of the filter's condition.



FILTER HOUSING WRENCH: A durable plastic tool designed to assist in loosening and tightening 10-inch filter housings. It provides a secure grip, making it easier to replace or maintain filter cartridges in water filtration systems.



FLOOR DRAIN: The floor drain is covered by a grate-type cover and is utilized both for circulation and when draining the Coast Freshe Barrel.

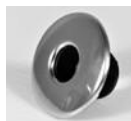

STAINLESS STEEL JET: A jet designed for water circulation and return flow in the Coast Freshe Barrel. It helps maintain water movement, ensuring proper filtration and even distribution of water for optimal comfort and efficiency.



FRESHE GFCI BOX: 15A GFCI Receptacle (Extra-Duty In-Use Weather Protection): A ground fault circuit interrupter (GFCI) outlet designed for Coast Freshe Barrel to work in outdoor or damp environments.



FRESHE WATER PUMP: Electrically powered pump designed to circulate water through a chiller system, ensuring efficient cooling.



AC/DC ADAPTER: A power supply device that converts current (AC) from GFCI outlet box into direct current (DC) to power the water pump.



PUMP PREFILTER/STRAINER: A device installed before the pump to capture debris and prevent clogging, improving pump performance and longevity.

OWNER'S MANUAL



BALL VALVE: A type of shut-off valve that controls water flow using a rotating ball inside the valve body.



DRAIN VALVE: A device used to release water from the Coast Freshe Barrel for maintenance or winterization.



TOPSIDE CONTROL PANEL (TSC): The user interface for adjusting and monitoring the Coast Freshe Barrel chiller unit's temperature and operational settings.



POWER SWITCH: A rocker-style switch that controls the power supplying to the chiller unit, that tilts between two positions, typically labeled "I" (On) and "O" (Off). Turning the Coast Freshe Barrel chiller on or off.

COAST FRESHE BARREL COLD PLUNGE GENERAL LAYOUT & SPECIFICATIONS

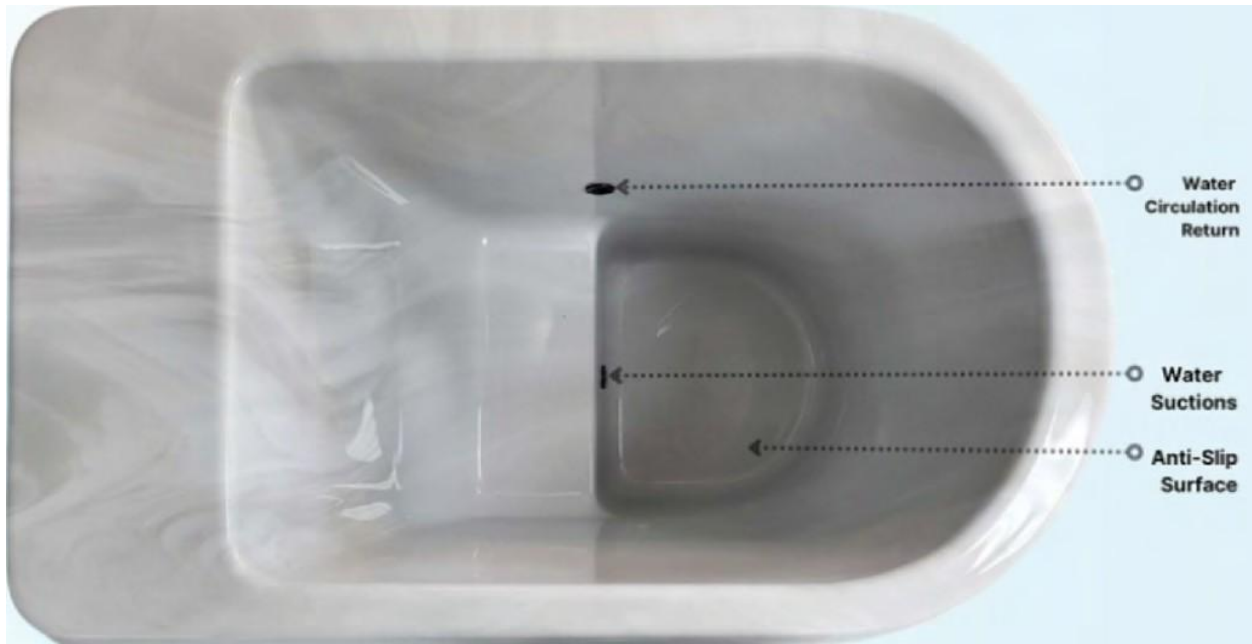

Series	Seats	Dimension (in) / (cm)	Capacity US gal / Litre	Dry Weight lbs / kg	Wet Weight lbs / kg
Coast Freshe Barrel	1	(49x29x40) /(125x74x101)	78 / 295	210 / 95	828 / 376

DISCLAIMER: At the time of print, this manual is accurate in its information. Coast Spas reserves all the rights to change/modify any designs and/or features without notification. To check on updates or for other information, please visit www.coastspas.com

COAST FRESHE BARREL COLD PLUNGE CHILLER

QUICK REFERENCE GUIDE

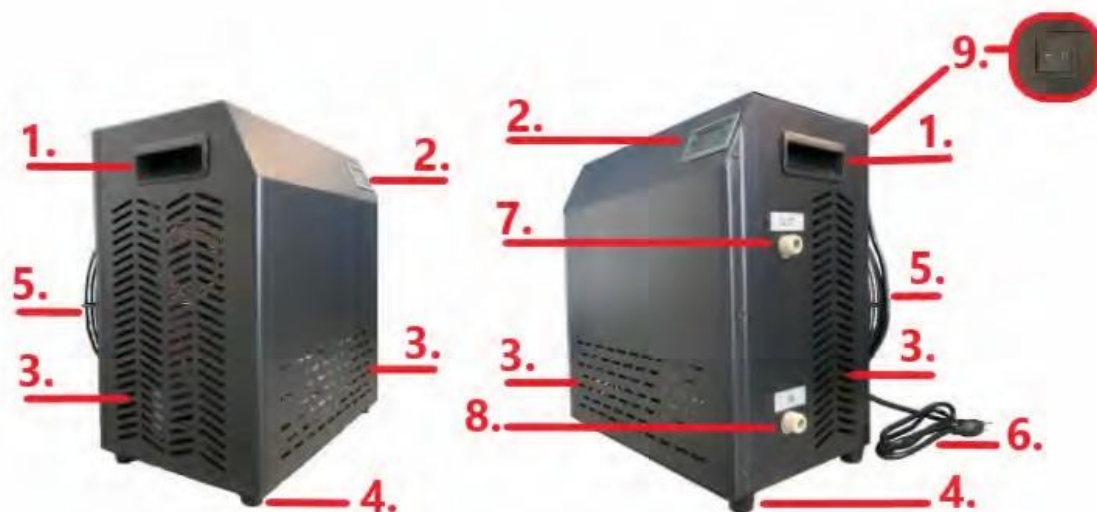

1. **Carry handles:** The Coast Freshe Barrel Chiller Carry Handle offers a sturdy, comfortable grip for effortless transport.
2. **Control Panel:** Displays information and enables easy operation of the Coast Freshe Barrel chiller.
3. **Vents:** Ensure proper airflow to maintain optimal operating temperatures for Coast Freshe Barrel equipment.
4. **Rubber Stander:** Stabilizes the Coast Freshe Barrel chiller and absorbs operational vibrations.
5. **Cooling Fan:** Ensures effective heat dissipation for optimal performance and longevity of the Coast Freshe Barrel chiller.
6. **Power Cord:** Connects the Coast Freshe Barrel chiller to an AC power outlet via the Coast Freshe GFCI box.
7. **Water Outlet:** Connects the water hose to the inlet of the Coast Freshe Barrel to return cooled water.
8. **Water Inlet:** Connects the water hose from the outlet of the Coast Freshe Barrel for cooling with the chiller.
9. **Power Switch:** Turns the Coast Freshe Chiller on and off.

COAST FRESHE BARREL

CONTROL PANEL OPERATING INTERFACE DESCRIPTION

HOME SCREEN DISPLAY













**Note: After enter setting, it will automatically exit after a few seconds if no further action is taken.*



START UP GUIDE

1. Wipe the surface of the Coast Freshe Barrel before first use to remove dust and residue.
2. Insert the fill hose into the "Coast Freshe Barrel" and add water until it reaches the appropriate level. Fill with distilled or tap water, leaving 4-4.5 inches/11.00 centimeters from the top. If the water contains high mineral levels it is recommended to use a prefilter. *Note: Avoid over filling the Coast Freshe Barrel*

OWNER'S MANUAL

3. Plug the power cord into an outlet to power up the Coast Freshe Barrel GFCI Box activate the water pump, allowing water to flow and circulate through the chiller system. If the pump makes a humming noise but no water movement, check the filter housing and strainer housing for airlock and follow the next step if needed.
4. Loosen the main filter housing and strainer housing to release any air lock, allowing water to fill the canister. Once the water reaches the top, tighten the housing back. *If the canister is already filled with water, you can skip this step.*
5. Remove the cap of the drain valve then open the drain valve to release any trapped air. Once the air is purged and the line is filled with water, close the valve and replace the cap.
6. Power on the chiller using the power switch. **Press**  as soon as the screen lights up to "Hold" the chiller compressor from starting before the settings are completed.
7. Short press  once, to enter the temperature setting. Once the "**Start Temp**" message begins to flash. Use  and  to adjust the temperature values.
8. Short press  once again, the "**Stop temp**" message will be flashing. Use  and  to adjust the temperature values.
9. Long press  to save and exit the temperature setting. **Note:** *The chiller will not operate if the set temperature is higher than the current water temperature.*
10. After 3 minutes, check the compressor indicator with the  symbol to confirm if it is solid or flashing. If it is flashing, short press the button  once to turn it on.
11. The compressor will activate, and the fan will start running. The chiller will gradually lower the water temperature to the set level.

Note: The **compressor** has a **3-minute delay** after each **start /reset** cycle.

**The real water temperature in the tub would be +1.5/-1 degrees Celsius of different with the temperature show on the screen because the water temperature sensor is not in the tub.*

COAST FRESHE BARREL

QUICK START UP CARD

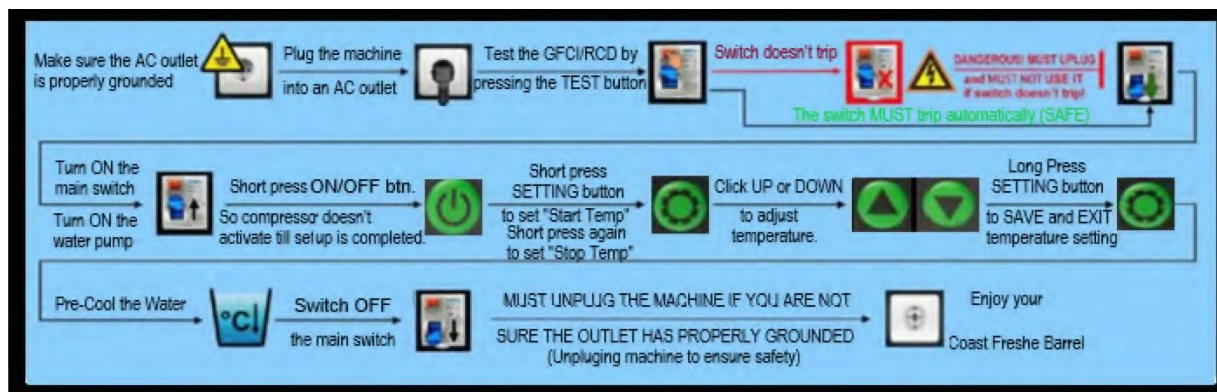

Button Operation Instructions			
Interface Button	Main Screen Display	Set Start/Stop Temperature	Set System Parameters
	Quickly press to enter the Start/Stop Temperature settings interface. Press and hold to enter the system parameter settings interface.	Quickly press to switch between the modified start and stop temperature values. Press and hold to save the value and exit.	Quickly press to toggle modified system parameters. Press and hold to save the value and exit.
	Short press: Not applicable. Long press: Not applicable.	Quickly press to Increase the parameter value. Press and hold to quickly increase the parameter value.	Quickly press to Increase the parameter value. Press and hold to quickly increase the parameter value.
	Quickly press to turn the screen backlight ON or OFF. Long press: Not applicable.	Quickly press to decrease the parameter value. Press and hold to quickly decrease the parameter value.	Quickly press to decrease the parameter value. Press and hold to quickly decrease the parameter value.
	Quickly press to toggle the emergency stop ON or OFF. Press and hold to enable or disable the button lock.	Short press: Not applicable. Long press: Not applicable.	Press quickly to toggle ON/OFF functions: OTP, LTP, dLy. Note: '---' indicates the function is turned OFF. Long press: Not applicable.

Note: Please refrain from modifying any parameters other than the **start temp, stop temp, compressor emergency ON/OFF**. Improper adjustments may cause the chiller to malfunction.

CONNECTING YOUR COAST FRESHE BARREL TO YOUR HOME WIFI

APP INSTALLATION

Use your smartdevice to **scan the QR code** located on the bottom of the device to download the **Sinilink APP**. Alternatively, you can download the **Sinilink APP** directly from your device's **App Store** choose iOS or Android link.

Once downloaded, **install the app** on your smartphone and **register an account** to proceed.



Scan this QR code to download the Mobile App

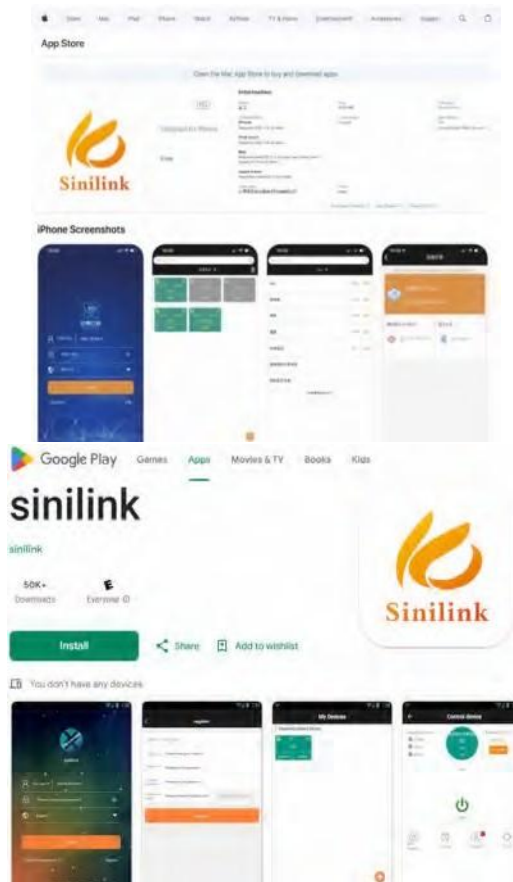

APP SETUP

Ensure that your smart device is connected to **Wi-Fi 2.4G only** and that **Bluetooth is enabled**. Also, confirm that both your smart device and the **Coast Freshe Barrel Chiller** are within the same **Wi-Fi 2.4G coverage area** before proceeding with the app setup.

Note: The Coast Freshe Barrel Chiller is not compatible with Wi-Fi 5G.

OWNER'S MANUAL



*Note: When your smart device detects "**Sinilink-APP**" in the Bluetooth search, **do not connect** to it directly. This Bluetooth connection must be made **within the app**.*

*If you have already paired it through your device's Bluetooth settings, please **cancel the pairing** and search again. Connecting outside the app may prevent successful pairing within the app.*

After downloading and installing the app, follow these steps to set up the Wi-Fi connection:

Step 1: Open the **Sinilink App** and **create an account**.

- Click “**Register**” under the **Login** tab.
- Follow the on-screen instructions to complete the registration process.



OWNER'S MANUAL

Step 2: Click on **"Add a Device"** or tap the **"+"** symbol in the lower right corner.

Ensure that your device is **connected to your home Wi-Fi (2.4G only)** before proceeding.



Step 3: Select **Compatibility Mode**.

Do not select **Touch Mode** or **Bluetooth Devices** during this step.



Step 4: On this screen, **do not select anything**. Simply click **"Next"** at the bottom without making any changes.

OWNER'S MANUAL

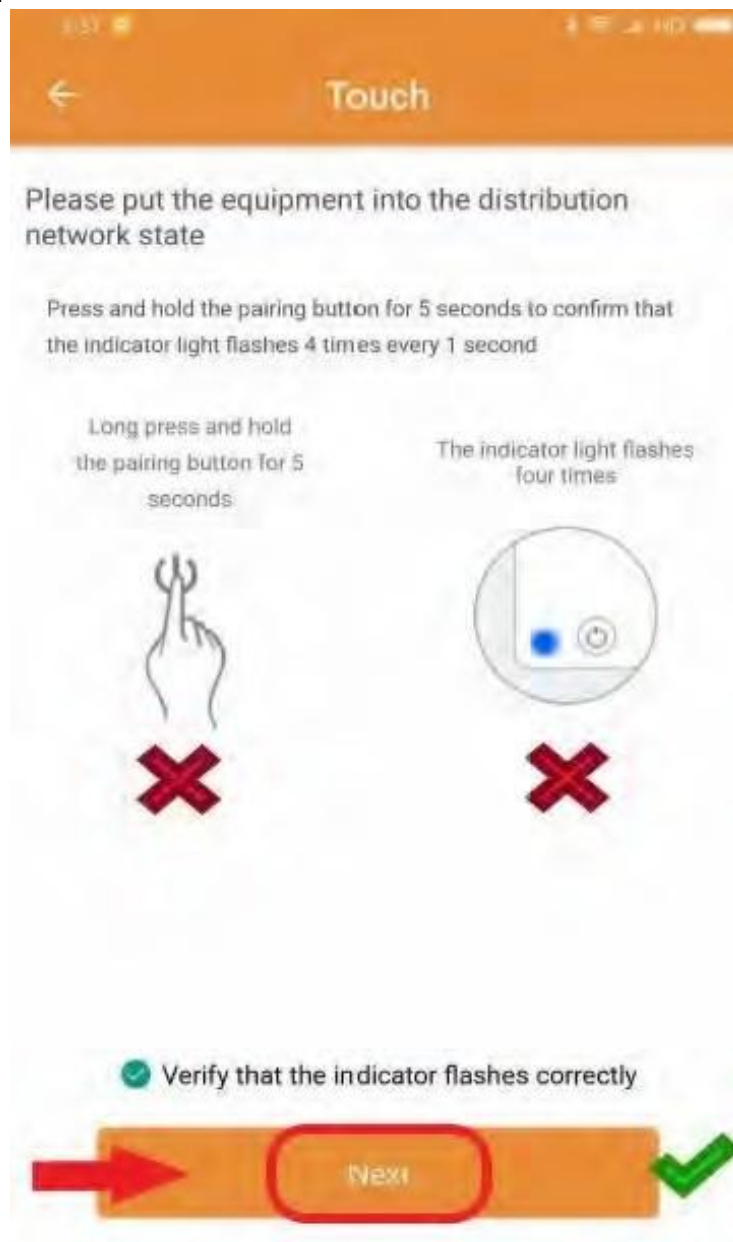

Step 5: Tap to select the **checkmark**, which will highlight it. This action will change the **"Next"** button from **grey to orange**. Then, tap **"Next"** to proceed

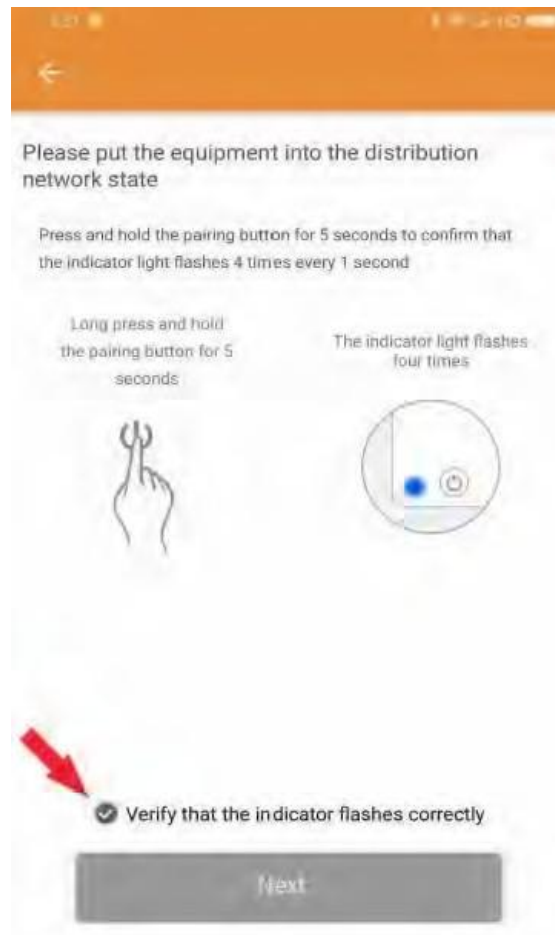

OWNER'S MANUAL

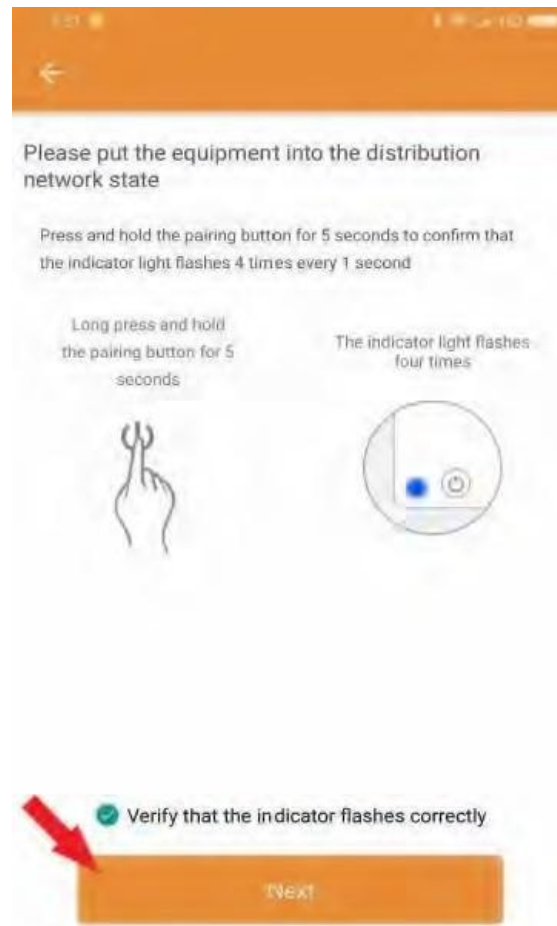

Step 6: Select your **home Wi-Fi (2.4G only)** and enter your **Wi-Fi password**, then click "**Next Step**" to continue.

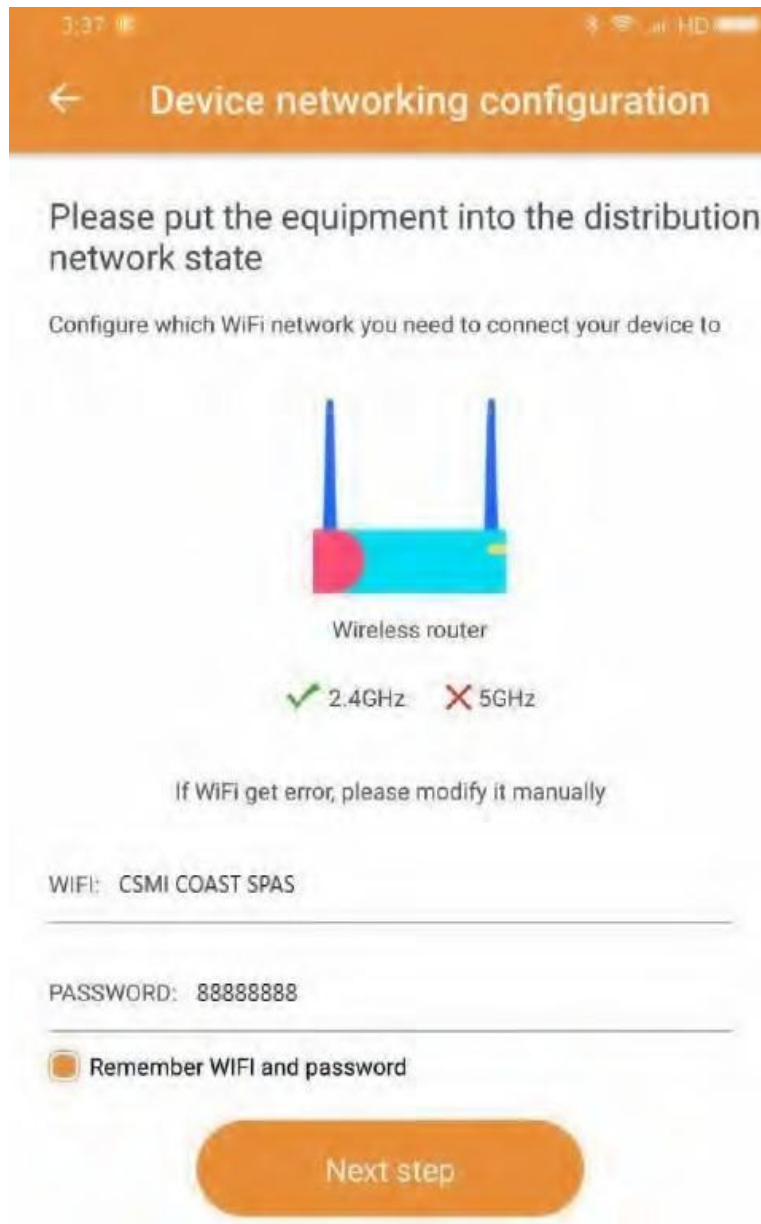

3:37

← Device networking configuration

Please put the equipment into the distribution network state

Configure which WiFi network you need to connect your device to

Wireless router

✓ 2.4GHz ✗ 5GHz

If WiFi get error, please modify it manually

WIFI: CSMI COAST SPAS

PASSWORD: 88888888

☒ Remember WIFI and password

Next step

Step 7: Enter a **custom name** for your **Coast Freshe Barrel**.

Next, tap the **drop-down arrow** to select the appropriate **device classification**.

The screenshot shows a mobile app interface titled "Connected Device" with an orange header. Below the header is a progress bar with three steps: 1. Enter WIFI password, 2. Input device information, and 3. Connection completed. Step 2 is currently active. Below the progress bar is an "Explain" section with instructions: "Press the matching button for a long time until the indicator flashes four times and then interrupts for one second (as shown below), when the device enters Touch matching mode." Below this is a "Set item" section with two fields: "Custom device name" (containing "COAST FRESHE BARREL") and "Please choose device classification" (a dropdown menu). Below these fields is a note "Up to 100 devices per category" and a large orange button labeled "Start the connection".

3:39

Connected Device

1 Enter WIFI password

2 Input device information

3 Connection completed

Explain

Press the matching button for a long time until the indicator flashes four times and then interrupts for one second (as shown below), when the device enters Touch matching mode.

Set item

Custom device name

COAST FRESHE BARREL

Please choose device classification

Up to 100 devices per category

Start the connection

Step 8: Add a **new classification**—you can name this **whatever you want**.

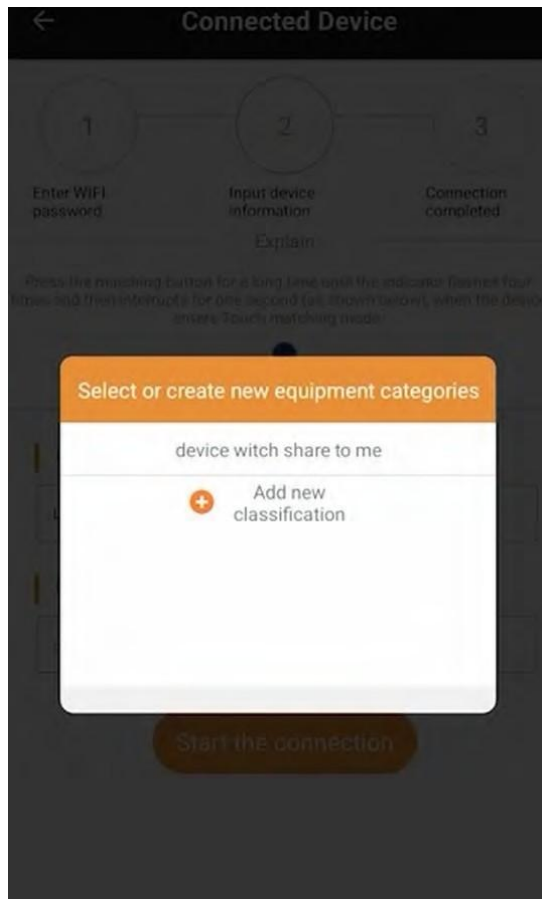

OWNER'S MANUAL

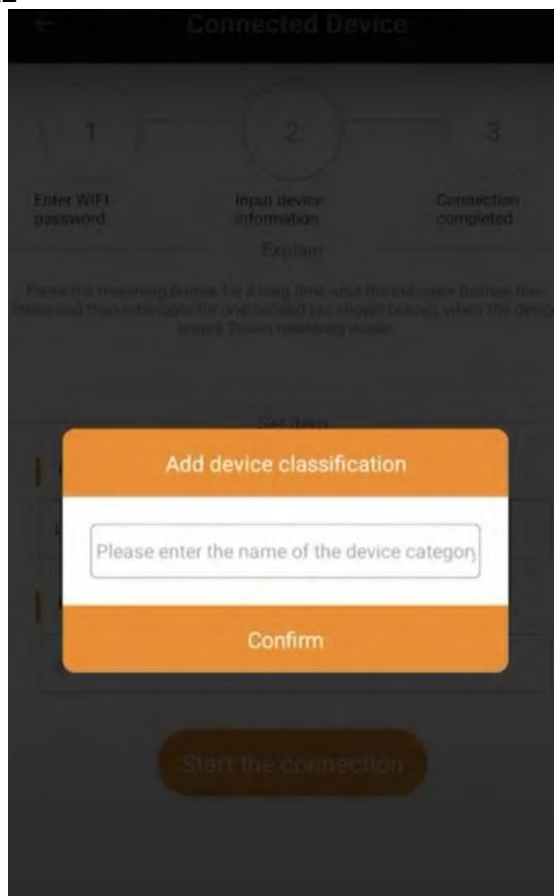

Step 9: Copy the **password**, then go to your **smart device's Wi-Fi settings**.

Note: *Do not press "Verify that the indicator flashes correctly."*



Step 10: Open your smart device's **Wi-Fi settings** menu, then go to the **Coast Freshe Barrel Chiller control panel** then press and hold the **up and down arrow buttons** for at least 5 seconds.

You will see "**SinilinkProduct**" appear in the network selection.

OWNER'S MANUAL



Step 11: Select "**SinilinkProduct**" from the Wi-Fi network list.

When prompted for a password, **paste the password** you copied from **Step 9** (12345678).



Step 12: Once connected to the **SinilinkProduct** network, exit the **Wi-Fi settings** on your smart device and return to the **Sinilink APP**. The connection should start **immediately**.

OWNER'S MANUAL



Step 13: Once you have successfully added your **Coast Freshe Barrel**, you will see the screen below. Select "**Back to Home Page**" to complete the setup.

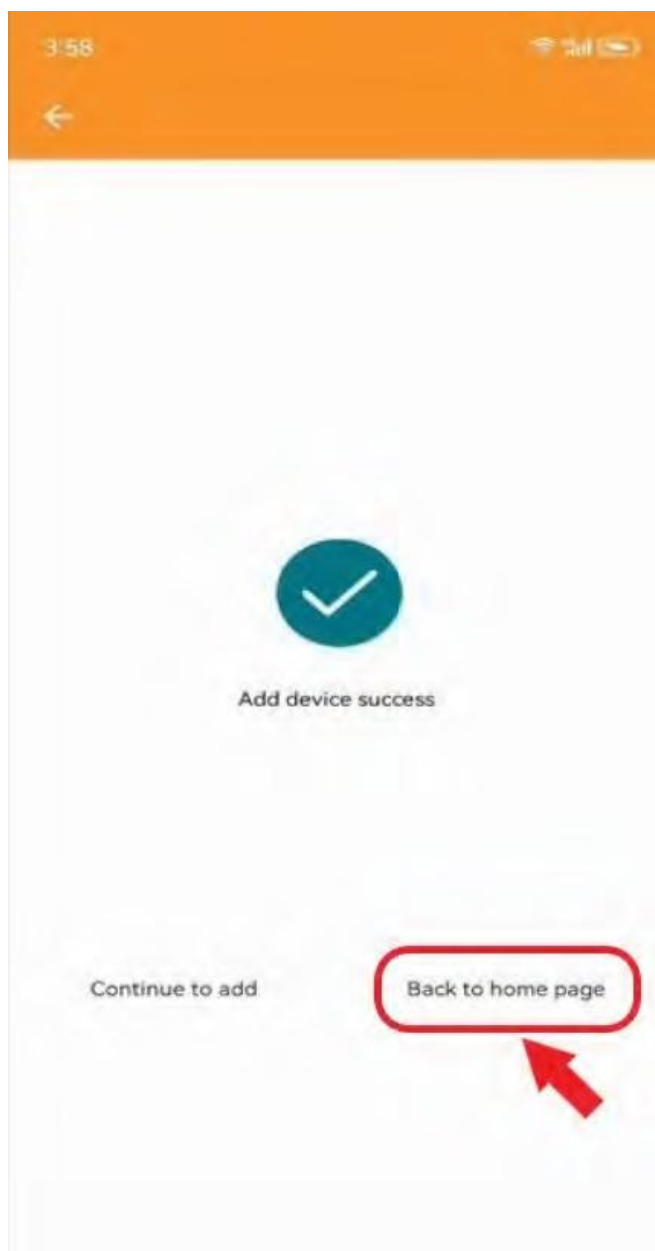

Step 14: Tap on the screen area where it says "**Control**" to access the device controls.

OWNER'S MANUAL



Step 15: The **operation interface** of the app will now appear, giving you full control of your **Coast Freshe Barrel Chiller** from your smart device.



The cooling unit turns **on** when the current temperature is **greater than or equal to** the start temperature and turns **off** when the current temperature is **less than or equal to** the stop temperature. The **Emergency Stop** button is used to **pause** the Coast Freshe Barrel **chiller**.

Note: Please refrain from modifying any parameters other than the three with check mark above (start temp, stop temp, compressor emergency OFF). Improper adjustments other values may cause the chiller to malfunction.

REGULAR MAINTENANCE PROCEDURES

OWNER'S MANUAL

DAY ONE (INITIAL START-UP) OR AFTER REFILLING WITH NEW WATER

- Clean the interior using a mild cleaning solution to remove residue and other contaminants.
- Fill the Cold Plunge Tub with distilled or tap water. If your tap water has high mineral content (e.g., frequent calcium or scale buildup around faucets), it is recommended to use a pre-filter to help protect the system from scaling.
- No chemicals are needed during the initial fill, as the water is fresh. Begin water treatment with appropriate chemicals after the first use or within two days, whichever comes first.

*** Note: Before using the Coast Freshe Barrel, it's recommended a quick shower to rinse off any lotions, oils, deodorants or other products from your body and swimwear. This helps prevent unwanted residues from entering the water and the chiller system.*

WEEKLY (OR AS NEEDED) There are **three simple steps** for weekly maintenance.

Step 1: Test the Water

- Quickly dip a test strip into the water and remove it to observe the color change. This typically takes **5-10 seconds** with cold water.

Step for balancing chemicals:

- Start by ensuring the **alkalinity** is approximately **100-120 ppm**. To increase the alkalinity, add **Alkalinity Booster** in **½ cap increments** and stir the water to ensure it dissolves.
- Once the water alkalinity is around **100-120 ppm**, check the **pH** and make sure it's within the range of **7.2 – 7.8**. To increase the pH, add **pH UP** in **¼ cap**

Steps for Sanitizing the Water:

- Once the water is balanced (alkalinity **100 – 120 ppm**, pH **7.2 – 7.8**), it's ready for sanitizing. Add **¼ cap (approximately 1 tbsp)** of **Harmonize** after soaking, stir the water to ensure the sanitizer dissolves, and leave the cover open for **30 minutes** to allow the chlorine to off-gas.
- Maintain the Coast Freshe sanitizer (**chlorine**) level around **0.5 – 1 ppm** when in use. This will minimize skin irritation and provide a better experience.

Step 2: Check and Clean the Water Pump Prefilter/Strainer

- Turn off the **Chiller** and close both **ball valves** by turning the handles.
- **Visually inspect the water pump prefilter** by removing the **Water Strainer Enclosure** (twist counterclockwise). Check the inner strainer for debris. Remove or wipe off any foreign materials. Rinse with a sponge if necessary.
- Before reinstalling the **Water Strainer Enclosure**, ensure that the **O-ring** at the base of the threads is present and free from damage.
- Additionally clean the exterior regularly using a mild cleaning solution to remove bacteria, residue, and other contaminants.

Step 3: Check and Clean the Main Water Filter Canister

- Inspect the **main water filter canister**. If it needs cleaning, follow the cleaning procedure. If no attention is required, you can skip this step and perform it during the **monthly maintenance procedure** when the filter cartridge is replaced.

increments, and to decrease the pH, add **pH DOWN** in **¼ cap increments**. It's important to add pH chemicals in small increments to maintain the pH in the 7.2 - 7.8 range.

MONTHLY (OR AS NEEDED)

FILTER REPLACEMENT

(Recommended to perform when the system is empty. If the system is full, follow the steps below.)

1. Power off the unit before beginning the replacement process.
2. Close both ball valves by turning it clockwise.
3. Using the provided filter wrench, loosen the filter canister by turning it clockwise.
4. Remove the canister and dispose the used filter.
5. Be prepared for some water to spill from the filter housing when removing the canister—have a towel or small container ready to catch excess water.
6. Clean the canister thoroughly, then insert a new filter.
7. Reopen the ball valve by turning it counterclockwise.

CLEANING THE VENTILATION SCREEN

1. **Start by detaching the top edge of each panel** by gently pulling it **outward at an angle** to release the magnets. Then **lift the ventilation screens upward** to fully remove them.
2. Carefully **place the three magnetized screens** on a clean surface.
3. Using a **damp cloth**, **wipe down both sides** of each screen to remove dust, dirt, and grime.
4. Once the screens are clean and dry, **slide them back into place**, aligning the bottom edge first, then **pressing the top back in to secure with the magnets**.

EVERY THREE to SIX MONTHS

DRAINING AND REFILLING THE WATER

Coast Freshe Barrel Self-Contained System

Is designed for easy filling from a hose, and with proper maintenance, the water can last **3 to 6 months**. It is **recommended to drain the water every 3 to 6 months** or as needed, depending on usage and water quality.

Draining Your Coast Freshe Barrel

Follow these steps to drain and clean the surface

1. **Turn off the Coast Freshe Cold Plunge** and disconnect the power.
2. **Remove the drain hose cap.**
3. **Attach the drain hose** to the garden hose (if needed).
4. **Turn the knob clockwise** to begin draining.
5. Clean the interior and exterior using a mild cleaning solution to remove bacteria, residue, and other contaminants.

Note: The Coast Freshe Cold Plunge drains by gravity. For faster drainage, you may use a **drain pump**.

BI-ANNUALLY (OR AS NEEDED)

DEEP CLEANING PLUMBING

1. Use hot water to perform a deep clean of the internal plumbing. Use an immersion heater to heat the water. Increase the temperature to 104°F (40°C).
2. Add one teaspoon of plumbing and jet cleaner (e.g., Whirlpool Tub Cleaner) to the water.
3. Run the system for a minimum of 30 minutes to allow the cleaner to circulate through the plumbing.
4. Drain the system completely, then refill with fresh water.



CHEMICALS (USA)

Coast Spas®

Coast Spas chemicals play a vital role in ensuring the longevity, cleanliness, and overall enjoyment of your hot tub or swim spa experience.

For optimal performance and to ensure the longevity of your Coast Spas Hot Tub, we strongly recommend using Coast Spas Chemicals. Our specially formulated chemicals have been crafted with the utmost precision and care, utilizing premium-grade ingredients and formulations designed to complement the unique engineering of your Coast Spas Hot Tub.

The use of alternative chemical products may lead to unintended chemical reactions, water imbalance, and possible damage to your spa's components. Moreover, it is important to note that failure to use Coast Spas Chemicals may impact your warranty coverage. To safeguard your investment and enjoy uninterrupted relaxation, trust in the quality and compatibility of Coast Spas Chemicals – the ideal choice for your Coast Spas Hot Tub.

HIGH QUALITY FORMULATION

Coast Spas hot tub and swim spa chemicals are designed by a team of experienced chemists who understand the unique needs of hot tubs. They are formulated to provide optimal performance and reliability in Coast Spas hot tubs, & swim spas ensuring that customers can enjoy their hot tubs for longer periods of time.

EASY TO USE

Coast Spas hot tub chemicals are designed to be easy to use and require minimal effort to maintain. This means that customers can spend less time worrying about maintaining their hot tubs and more time enjoying them.

RELIABLE AND EFFICIENT

Coast Spas hot tub chemicals are safe and effective, providing a superior user experience for customers. They are designed to work seamlessly with Coast Spas hot tubs, ensuring that customers can enjoy their hot tubs without any issues.

SCAN THIS QR
TO DOWNLOAD
BROCHURE



SCAN ME

Discover our essential products
designed for clean and balanced hot tub
and swim spa water.



CHEMICALS (CANADA)

Coast Spas®

Coast Spas chemicals play a vital role in ensuring the longevity, cleanliness, and overall enjoyment of your hot tub or swim spa experience.

For optimal performance and to ensure the longevity of your Coast Spas Hot Tub, we strongly recommend using Coast Spas Chemicals. Our specially formulated chemicals have been crafted with the utmost precision and care, utilizing premium-grade ingredients and formulations designed to complement the unique engineering of your Coast Spas Hot Tub.

The use of alternative chemical products may lead to unintended chemical reactions, water imbalance, and possible damage to your spa's components. Moreover, it is important to note that failure to use Coast Spas Chemicals may impact your warranty coverage. To safeguard your investment and enjoy uninterrupted relaxation, trust in the quality and compatibility of Coast Spas Chemicals – the ideal choice for your Coast Spas Hot Tub.

HIGH QUALITY FORMULATION

Coast Spas hot tub and swim spa chemicals are designed by a team of experienced chemists who understand the unique needs of hot tubs. They are formulated to provide optimal performance and reliability in Coast Spas hot tubs, & swim spas ensuring that customers can enjoy their hot tubs for longer periods of time.

EASY TO USE

Coast Spas hot tub chemicals are designed to be easy to use and require minimal effort to maintain. This means that customers can spend less time worrying about maintaining their hot tubs and more time enjoying them.

RELIABLE AND EFFICIENT

Coast Spas hot tub chemicals are safe and effective, providing a superior user experience for customers. They are designed to work seamlessly with Coast Spas hot tubs, ensuring that customers can enjoy their hot tubs without any issues.

SCAN THIS QR
TO DOWNLOAD
BROCHURE



SCAN ME

Discover our essential products
designed for clean and balanced hot
tub and swim spa water.

QUICK TROUBLESHOOTING GUIDE TABLE

COAST FRESHE BARREL SPECIFICATION

Power Supply	100~ 120VAC 60Hz
Input Power	1200W
Compressor Power	1100W
Cooling capacity	3000W
Control Panel Type	LCD with Button Switches
Heating Function	N/A
Ozone	N/A
Refrigerant	R410A
Circulation Pump	Installed External
Water Filter (20 Micron Filtration)	Installed External
Wireless Control	Yes, IOS & Android APP, 2.4 GHz WIFI
Weatherproof Cover	Included
Insulated	Yes
Temperature Cooling Range	37°F / 3°C
Operating Temperature Range	37°F ~ 105°F / 3°C ~40°C
Max. Ambient Temperature Range	1°C ~ 45°C
Storage Temperature:	-20°C ~ 55°C
Storage Relative Humidity:	20% ~ 85% (Ensure no water inside chiller's internal)
Cooling 73°F ~ 41°F / 23°C ~ 5°C	79 gal / 299L = 4.0 Hrs.
Max. Water Chiller Cooling Cap.	80 gals / 300L
Chiller dimensions L x W x H	17"x12"x16" / 42.5cm*31cm*40cm

Chiller Net weight	56 lbs. / 25.6 kg
Water Capacity	78 gal / 295.25 L
Barrel dimensions L x W x H	49.5" x 29.5" x 40" / 125.7cm*74.9cm*101.6cm
Barrel Dry Weight	210 lbs. / 95.25 kg
Tub Filled Weight	828 lbs. / 375.6 kg

DETAILED TROUBLESHOOTING GUIDE

If your chiller is not functioning properly, follow these steps to diagnose and resolve common issues. Regular maintenance and proper setup are key to ensuring optimal performance.

Issue	Possible Cause	Recommended Solution
1. Low Water Flow / Weak Discharge	<ul style="list-style-type: none"> - Pipe may be bent or kinked - Filter element may be clogged 	<ul style="list-style-type: none"> - Inspect all hoses for bends or blockages- Replace the filter element
2. Abnormal Compressor Noise or Vibration	<ul style="list-style-type: none"> - Incorrect input voltage - Poor ventilation - Water temperature exceeds 38°C - Ambient air temperature above 32°C - Fan malfunction or reduced airflow 	<ul style="list-style-type: none"> - Check and correct input voltage - Ensure chiller has proper ventilation - Lower water temp below 38°C - Improve ambient airflow - Verify fan is operating normally
3. Slow or No Cooling	<ul style="list-style-type: none"> - Incorrect input voltage- Poor ventilation - Fan blowing hot air onto tub - Ambient air too hot (>32°C) - Poor tub insulation or lid not used - Fan airflow significantly reduced 	<ul style="list-style-type: none"> - Confirm input voltage - Improve chiller ventilation - Redirect fan away from tub - Reduce surrounding air temperature - Use insulated lid properly - Check fan functionality
4. Display Screen Won't Light Up	<ul style="list-style-type: none"> - Power cord not connected- Incorrect input voltage- SA30 controller cable loose 	<ul style="list-style-type: none"> - Ensure power is connected- Verify input voltage- Open unit and check TSC power cable
5. Abnormal Temperature Display	<ul style="list-style-type: none"> - External heat source near water line - Uneven water temperature - Poor contact on thermometer signal wire 	<ul style="list-style-type: none"> - Remove heat sources near pipe - Stir water to even out temperature - Check signal cable connection on TSC
6. Incorrect High/Low Temp Alarm (Real Temp Between 1–42°C)	<ul style="list-style-type: none"> - App temperature alarm values incorrectly set - Thermometer error (see issue #5) 	<ul style="list-style-type: none"> - Adjust app alarm settings - Recheck temp sensor and connections
7. Circulation Pump Not Working	<ul style="list-style-type: none"> - No power to pump - Pump transformer not outputting 24V DC - Faulty pump 	<ul style="list-style-type: none"> - Test voltage at pump power source - Verify 24V DC output from transformer - Replace pump if both above are normal
8. Screen is On, but Compressor and Fan Never Start (over 3 mins)	<ul style="list-style-type: none"> - No voltage to chiller - Loose wire between TSC and compressor 	<ul style="list-style-type: none"> - Confirm chiller is receiving power - Open case and secure TSC wiring –compressor wiring

Chiller Not Turning On

1. **Check Power Supply**
 - a. Ensure the chiller is plugged into a working outlet.
 - b. Verify the GFCI/GCD plug is not tripped.
2. **Inspect Circuit Breaker**
 - a. If tripped, reset it and try again.

Chiller Not Cooling

1. **Verify Controller Status**
 - a. Check if the LCD display has power.
 - b. Ensure the LED/Working Light symbol is lit on the controller.
 - c. If not, check the controller settings to confirm it is calling for cooling.
2. **Compressor Functionality**
 - a. Ensure the compressor turns on and the controller readout remains steady.
3. **Check Airflow**
 - a. Confirm airflow from the right side of the chiller is unobstructed.
 - b. Check for clogs in the coil or blockages in ventilation.
4. **Assess Air Temperature**
 - a. If warm air is coming from the right side, the chiller is at least partially cooling.
 - b. If air is room temperature, further troubleshooting is needed.
5. **Verify Water Temperature**
 - a. Use an external thermometer (not an IR gun) to check actual water temperature.
 - b. Compare readings from:
 - i. **Ambient air temperature**
 - ii. **Chiller display reading**
 - iii. **External thermometer measurement**
 - c. Clearly identifying temperature sources is crucial for accurate troubleshooting.
6. **Ambient Temperature Consideration**
 - a. High room temperature can reduce cooling efficiency. Relocate the chiller to a cooler area if possible.

No Water Flow Back into Tub/Tank

1. **Check for Blockages**
 - a. Ensure the filter is clean and not restricting water flow.
 - b. If there is a valve on the tub drain, make sure it is fully open.
2. **Perform Gravity Flow Test**

(Ensure the chiller is unplugged for at least 30 minutes before performing this test.)

 - a. Remove the filter from its housing and reattach the housing without the filter.
 - b. Disconnect the **inlet fitting** – verify strong gravity-fed water flow. Reconnect the fitting.
 - c. Disconnect the **outlet fitting** – ensure good gravity flow before reconnecting.
 - d. Disconnect the **filter connection fitting**, lower the tubing, and check for water flow.
 - e. Plug the chiller back in, observe water flow increase, and reconnect the fitting.
3. **Backflush the System** *(If water flow issues persist)*
 - a. Remove the tubing from the outlet of the chiller.
 - b. Use a garden hose to flush the system **backwards** through the outlet.
 - c. Continue flushing for 15-30 seconds until air bubbles stop appearing in the tub.
 - d. Reconnect the tubing, turn on the chiller, and check for restored water flow.
4. **Identify Flow Obstructions**
 - a. If water is not flowing at any step, determine where the blockage occurs (inlet, outlet, filter hose, etc.).

Pump Circulation Issues

1. **Check Hose Connection**
 - a. Ensure the hose from the ice bath is securely attached to the pump.
 - b. Look for kinks, loose connections, or blockages restricting flow.
2. **Ensure Proper Positioning**
 - a. The water level in the ice bath should be **higher than the chiller's inlet**.
 - b. This allows gravity to assist water flow and prevent air pockets.
3. **Prime the Pump**
 - a. If the pump is not pulling water, disconnect it, fill it with water, then reconnect.
 - b. This removes trapped air and restores proper function.
4. **Restart the System**
 - a. Turn off the chiller and pump, wait a few minutes, then restart them.
 - b. This can help reset internal components and clear minor issues.
5. **Inspect for Obstructions**
 - a. Check the pump's intake for debris or clogs hindering flow.
 - b. Ensure the filter assembly is clean and free of air pockets.
6. **Still Not Working?**
 - a. If circulation issues persist, contact your seller for assistance.
 - b. Provide a **video of your setup** and describe the issue in detail.

Other Common Issues

1. Unusual Noises

- a. Check for obstructions in vents and fans.
- b. Secure loose components to prevent rattling.

2. Water Leakage

- a. Ensure all hoses and fittings are securely connected.
- b. Inspect for cracks or damage causing leaks.

3. Error Messages on Display

- a. Refer to the user manual for specific error codes.
- b. Reset the chiller by turning it off, waiting a few minutes, and restarting.

4. Chiller Overheating

- a. Ensure proper ventilation and avoid placing the chiller in a confined space.
- b. Monitor ambient temperature, as excessive heat can cause overheating.

Defrosting a Frozen Chiller

If you are experiencing reduced or no water flow, it may be due to ice formation inside the chiller. This can happen if the chiller is still running in freezing conditions or if outdoor temperatures are below freezing.

Steps to Defrost Your Chiller:

1. **Drain the System:** Completely drain your **Coast Freshe Barrel**.
2. **Move Components Indoors:** Bring the water filter canister and chiller inside to a warmer environment.
3. **Allow Time for Defrosting:** Wait at least **4 hours**, then check if the chiller has thawed.
4. **Remove Excess Water:** Turn the chiller upside down to drain any remaining water inside.
5. **Confirm Defrosting**
 - a. Pour water into the **"Inlet"** connection.
 - b. Cover the "Inlet" with your hand and turn the chiller upside down. If water flows out of the **"Outlet"**, the chiller has defrosted.
 - c. Alternatively, pour water into the **"Inlet"** and blow into the connection. If water comes out of the **"Outlet"**, the chiller is clear. (*Caution: Water may spray / splash.*)
6. **Additional Defrosting Time:** In some cases, it may take **24–48 hours** for the chiller to fully defrost.
7. **Test the System:** Refill your **Coast Freshe Barrel** and check if the flow issue is resolved.

By following these steps, you can restore proper function to your chiller and prevent freezing related issues in the future.

Regular Maintenance is Key

To ensure optimal performance and longevity of your **Cold Plunge Chiller**, follow these maintenance tips:

- Keep the unit **clean** and well-ventilated.
- Regularly **check and clean the filter** to prevent clogs.
- Ensure proper **water chemistry** to avoid damage.
- Never operate the chiller without adequate water flow.

If troubleshooting steps do not resolve the issue, contact your **selling dealer's customer support or service team**. Providing a **detailed description, photos, or videos** of your setup will help them diagnose and assist you more efficiently.

COAST FRESHE BARREL: WATER CLARITY TROUBLESHOOTING GUIDE

PROBLEM	PROBABLE CAUSE	POTENTIAL SOLUTIONS
Water Odor	<ul style="list-style-type: none"> - Improper sanitization - Excessive organics in water - pH is too low 	<ul style="list-style-type: none"> - Add sanitizer - Shock with sanitizer - Adjust pH
Chlorine Odor	<ul style="list-style-type: none"> - Chloramines are too high - pH is too low 	<ul style="list-style-type: none"> - Shock with sanitizer - Adjust pH
Musty Odor	<ul style="list-style-type: none"> - Bacteria or algae growth 	<ul style="list-style-type: none"> - Shock with sanitizer - Drain and refill water
Scale	<ul style="list-style-type: none"> - Total alkalinity is too high - pH is too high - High calcium content in water 	<ul style="list-style-type: none"> - Adjust total alkalinity - Adjust pH - Use stain and scale product
Stains	<ul style="list-style-type: none"> - Total alkalinity is too low - pH is too low - High metal content in water 	<ul style="list-style-type: none"> - Adjust alkalinity - Adjust pH - Use stain and scale product
Cloudy Water	<ul style="list-style-type: none"> - Poor filtration - pH is too high - Hardness is too high - Total alkalinity is too high - Suspended particles 	<ul style="list-style-type: none"> - Clean filter cartridge - Adjust pH - Adjust hardness - Adjust total alkalinity - Drain and refill water
Algae Growth	<ul style="list-style-type: none"> - pH is too high - Sanitizer is too low 	<ul style="list-style-type: none"> - Adjust pH - Shock with sanitizer - Adjust sanitizer level
Eye Irritation	<ul style="list-style-type: none"> - pH is too low - Sanitizer is too low 	<ul style="list-style-type: none"> - Adjust pH - Shock with sanitizer - Adjust sanitizer level
Skin Rash/Irritation	<ul style="list-style-type: none"> - Free chlorine level too high - Unsanitary water 	<ul style="list-style-type: none"> - Adjust chlorine level - Shock with sanitizer - Adjust sanitizer level

Note: This guide will help resolve common water clarity issues in your Coast Freshe Barrel. For further assistance, please contact your selling dealer or service provider.

Coast Barrel How-To Videos



Start-up and Filling



Care & Maintenance



Filter Replacement



Draining Instructions

SERVICE TRACKER

Service Performed

Date

[illegible]

WORLD'S BEST BUILT SPAS